

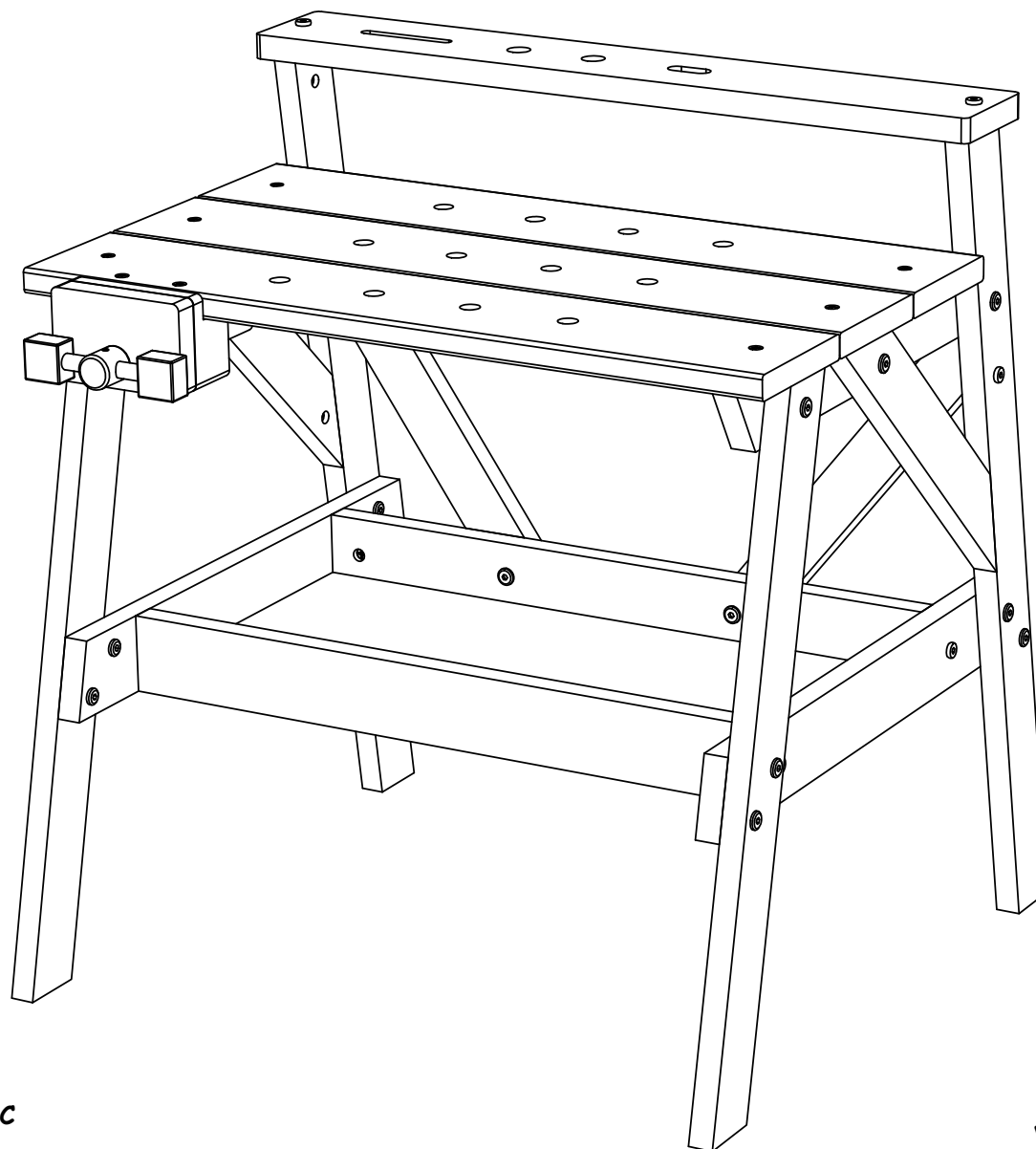

WORKBENCH ASSEMBLY INSTRUCTIONS



HARDWARE INCLUDED

10- DN1

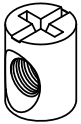

16- MB1

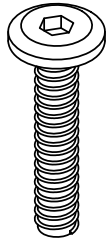

8- MB2

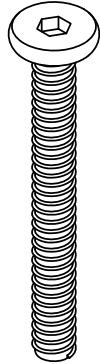

2- MB3

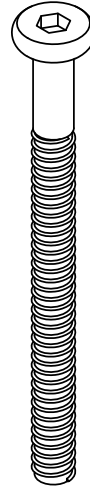

8- WS1

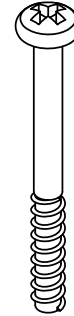

16- CN1



2- HK1

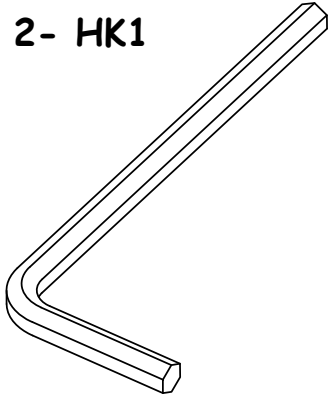

YOU SUPPLY...

1- philips screwdriver

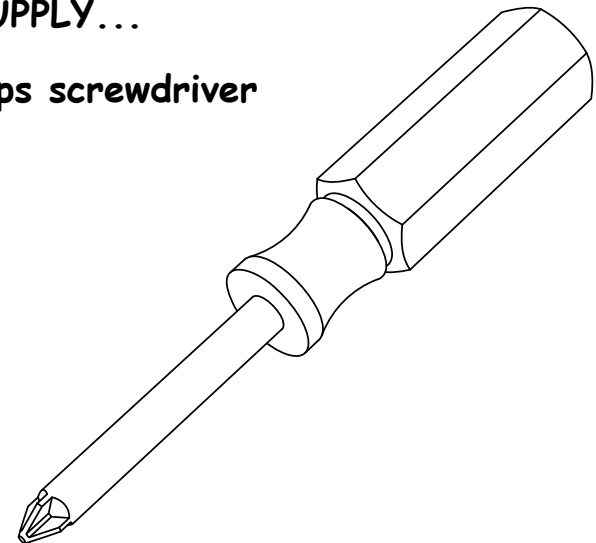

PARTS INCLUDED

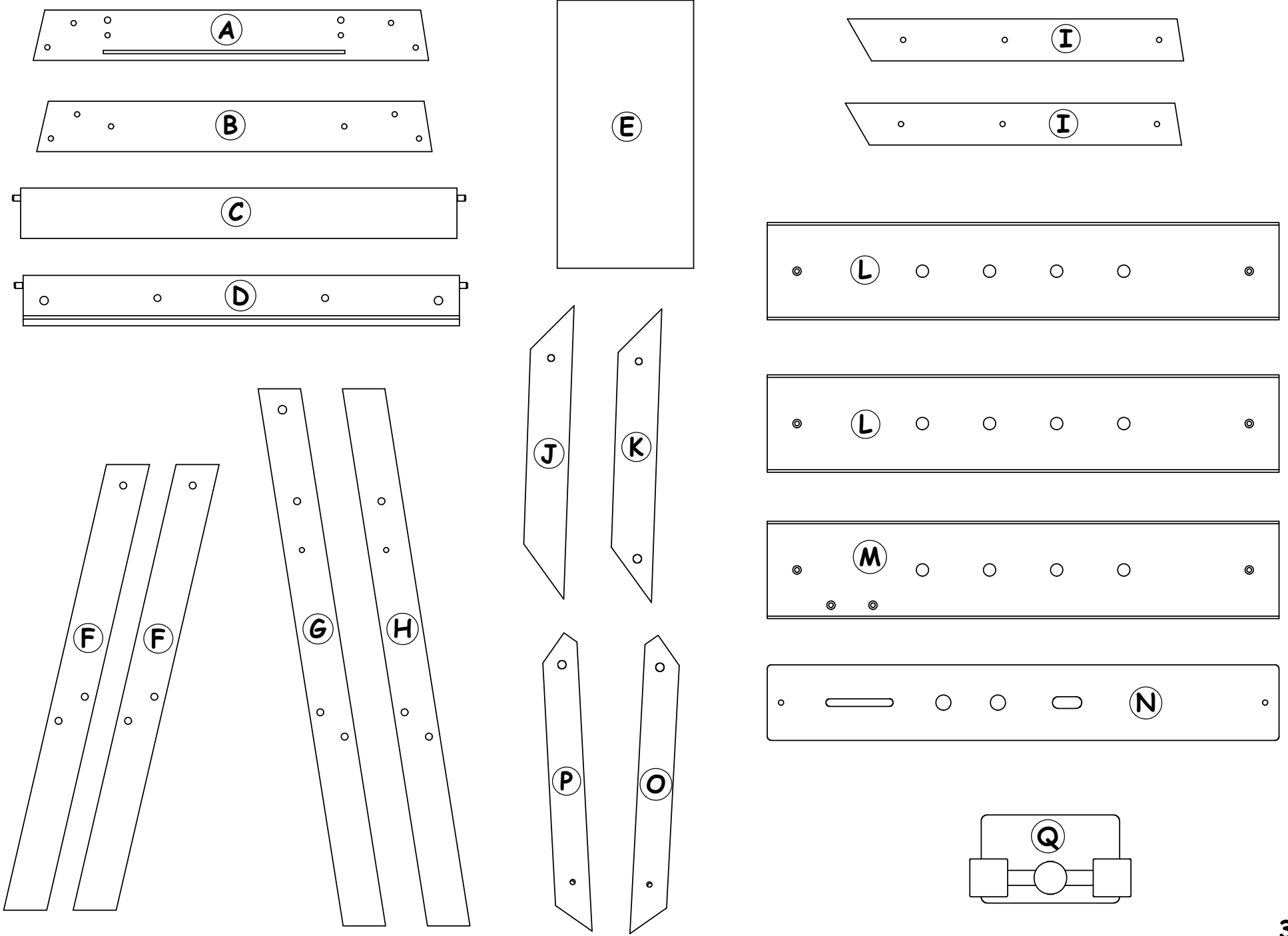

1 Use 4- MB2 bolts and 4- DN1 nuts to assemble lower tray.

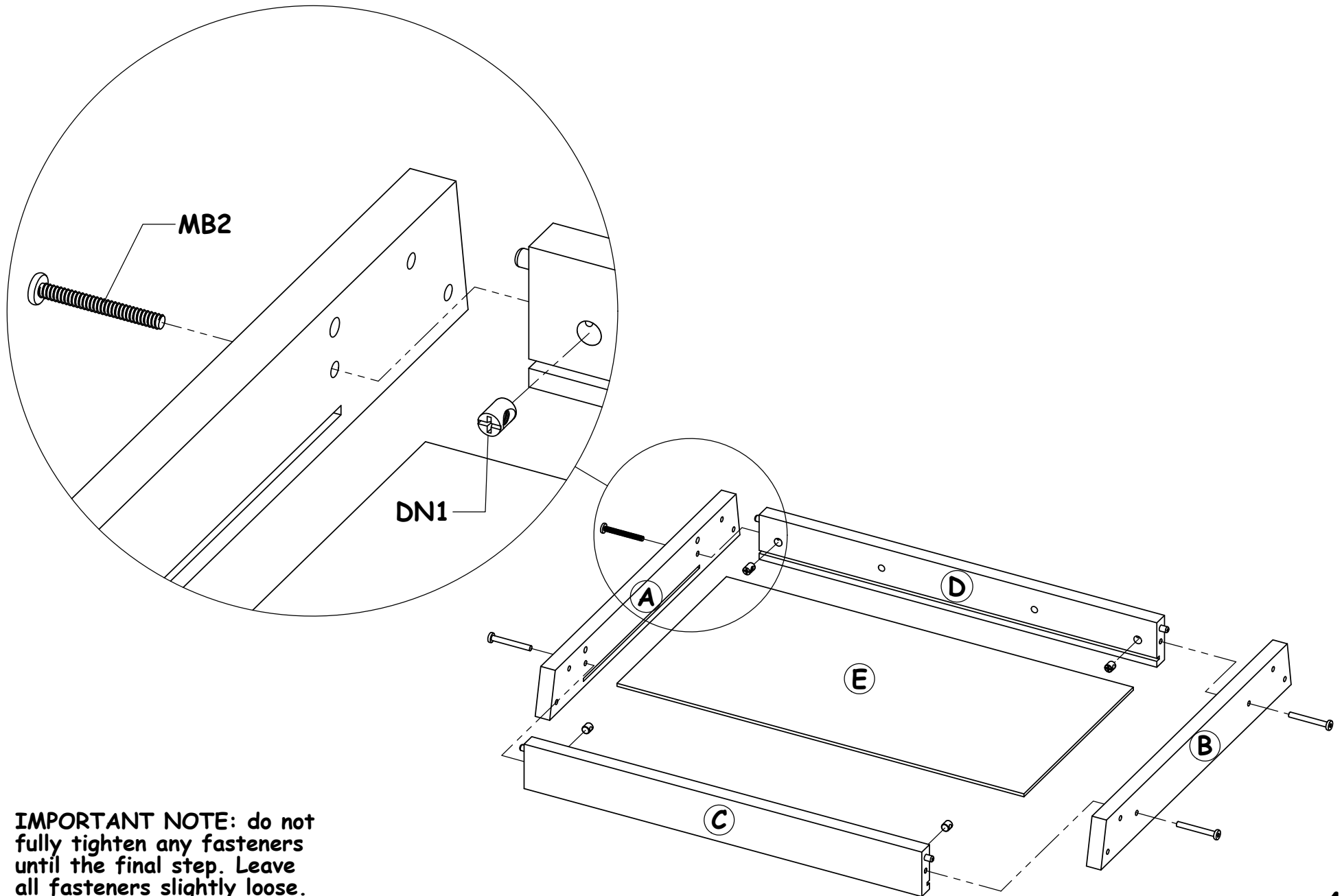

IMPORTANT NOTE: do not fully tighten any fasteners until the final step. Leave all fasteners slightly loose.

2 Use 8- MB1 bolts and 8- CN1 nuts to attach front and back legs to assembled tray

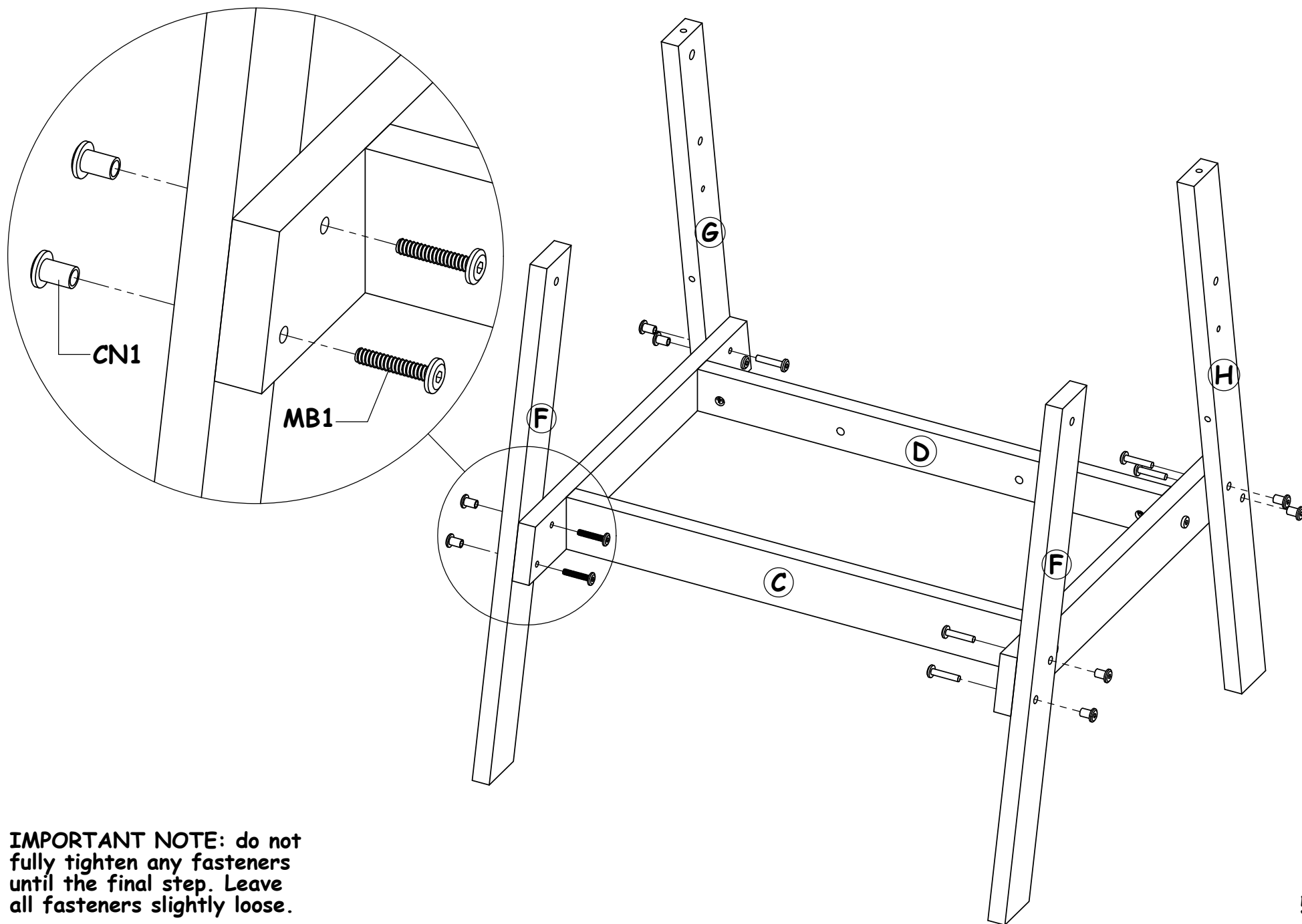

IMPORTANT NOTE: do not fully tighten any fasteners until the final step. Leave all fasteners slightly loose.

3 Use 4- MB1 bolts and 4- CN1 nuts to attach upper sides to legs

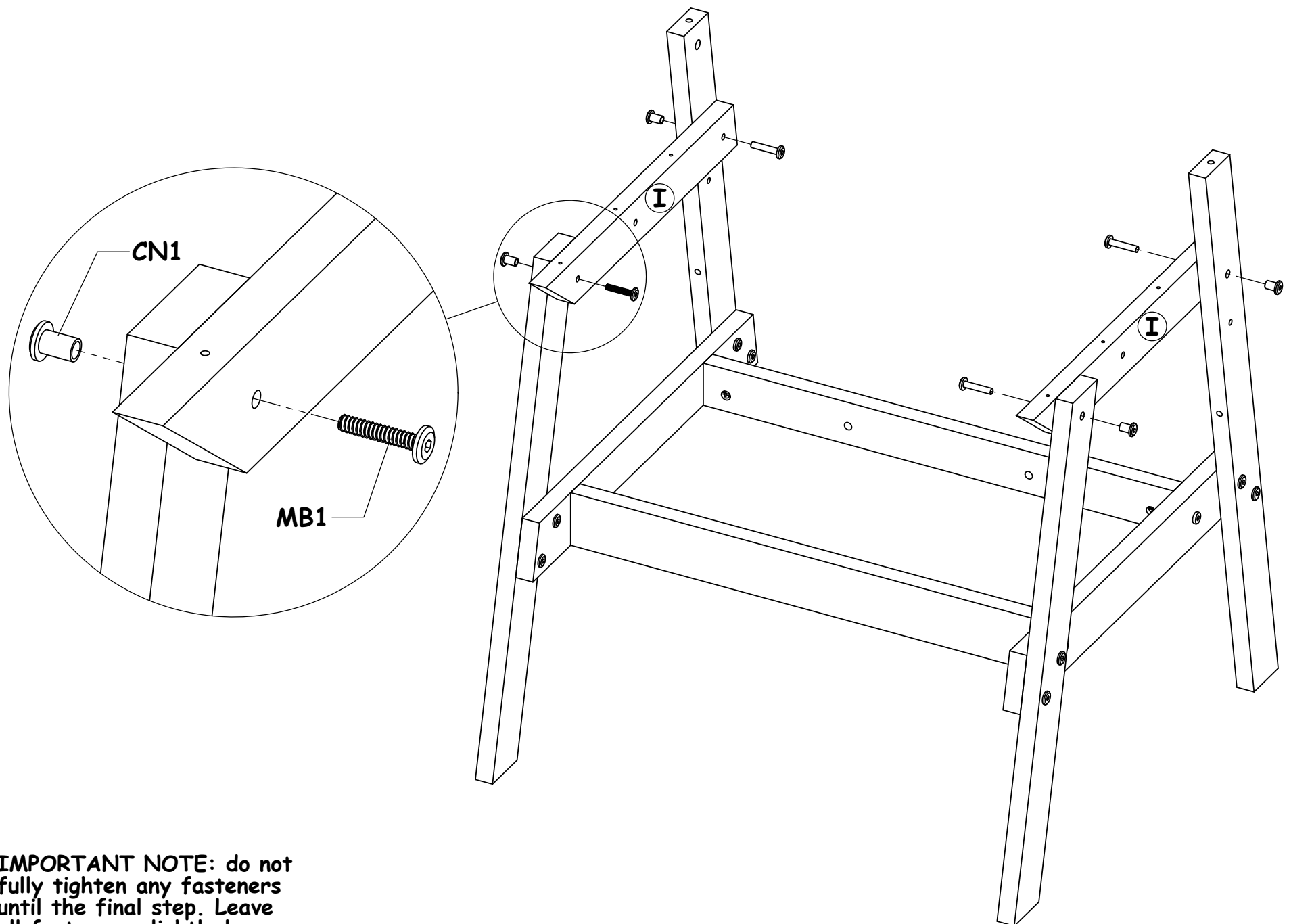

IMPORTANT NOTE: do not fully tighten any fasteners until the final step. Leave all fasteners slightly loose.

- 4** Use 2- MB1 bolts and 2- CN1 nuts to attach cross braces to upper sides. Use 2- MB3 bolts and 2- DN1 nuts to attach cross braces to back legs.

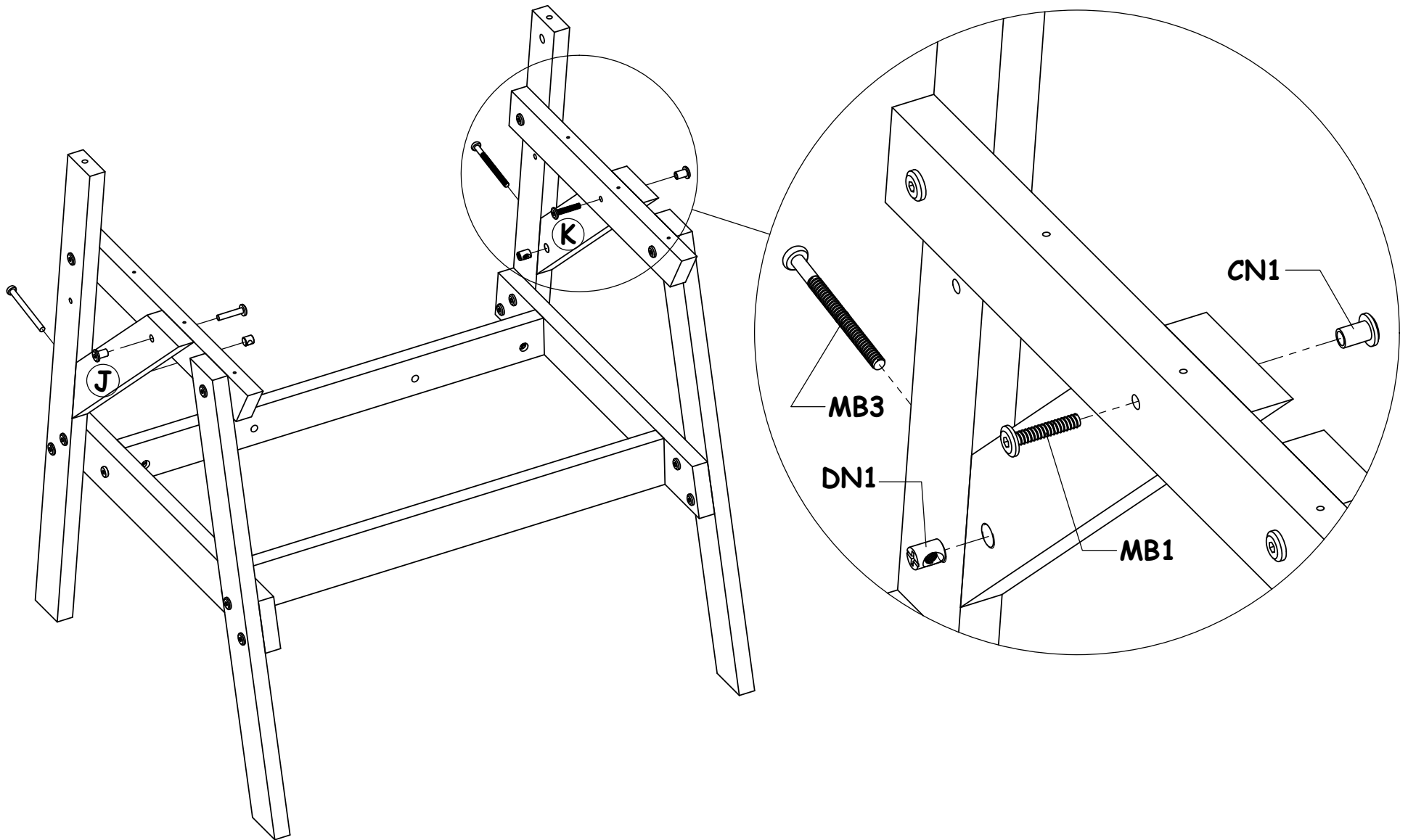

IMPORTANT NOTE: do not fully tighten any fasteners until the final step. Leave all fasteners slightly loose.

5 Use 6- WS1 screws to attach workbench top planks to upper sides.

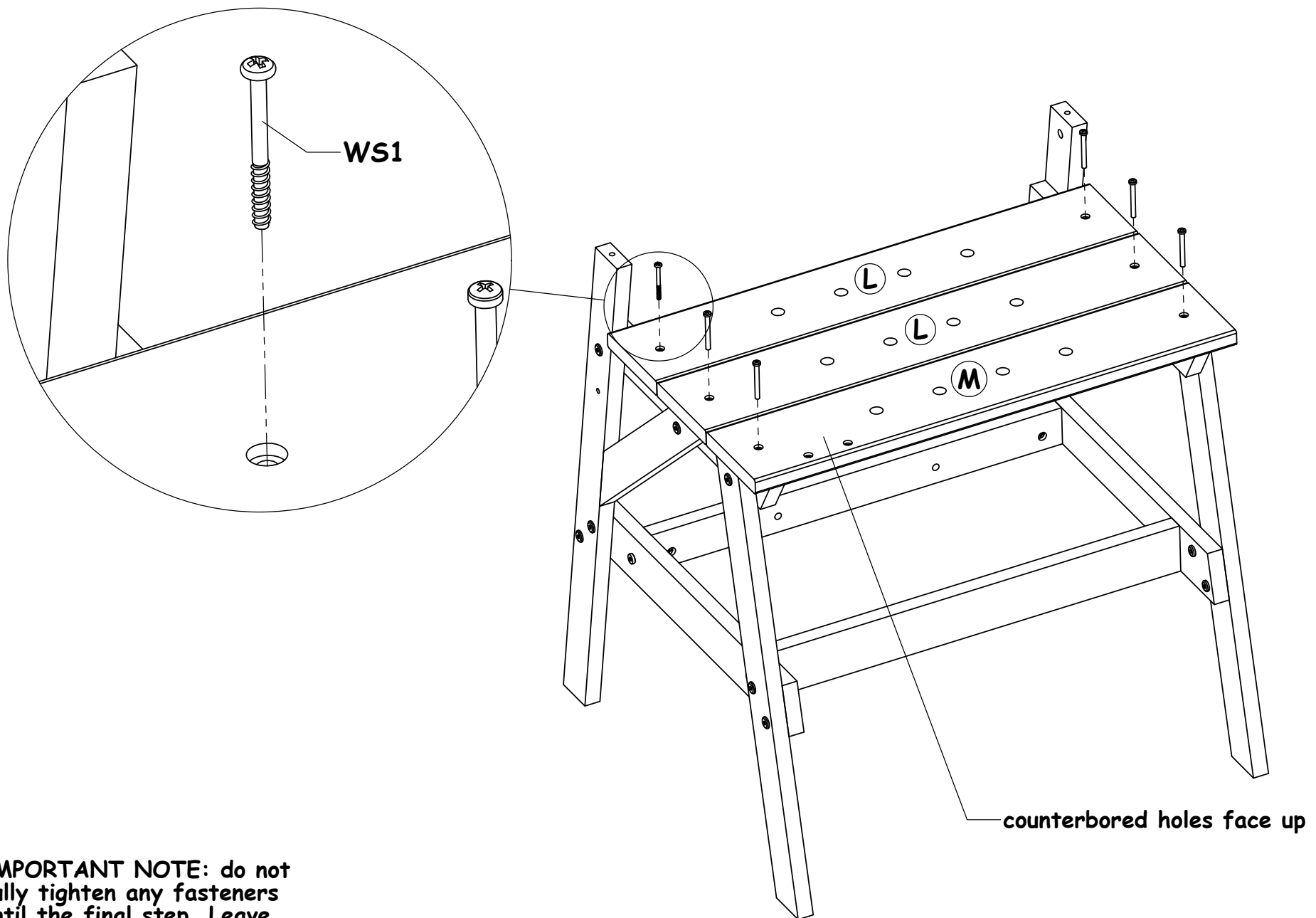

IMPORTANT NOTE: do not fully tighten any fasteners until the final step. Leave all fasteners slightly loose.

6 Use 2- WS1 screws to attach vice assembly. Use 2- MB2 bolts and 2- DN1 nuts to attach tool holder

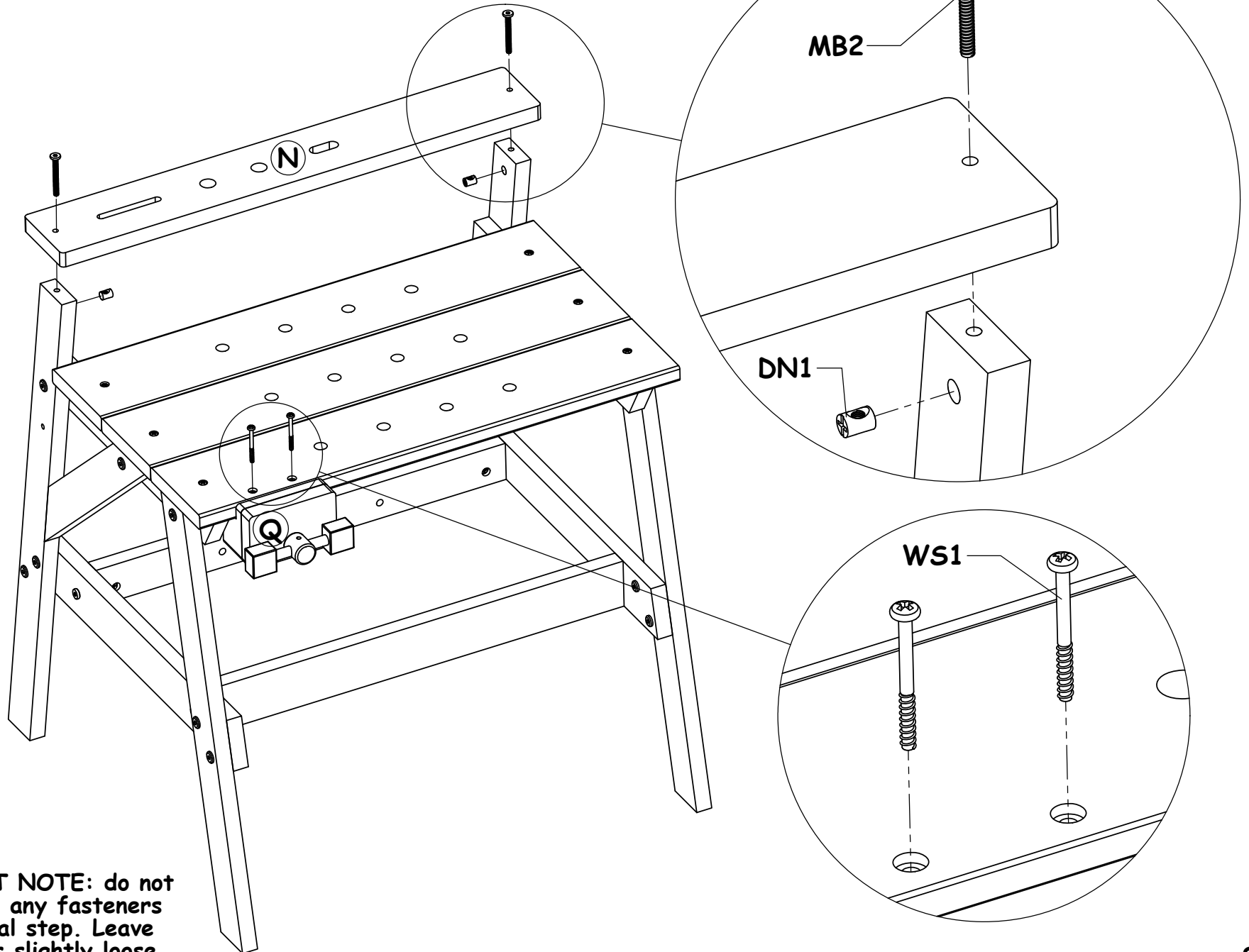

IMPORTANT NOTE: do not fully tighten any fasteners until the final step. Leave all fasteners slightly loose.

7 (FINAL STEP) Use 2- MB1 bolts and 2- CN1 nuts to attach back braces to tray side. Use 2- MB2 bolts and 2- DN1 nuts to attach back braces to back legs. Now tighten all fasteners.

